

P.C.B LAYOUT MOUNTING PATTERN
(TOP VIEW)

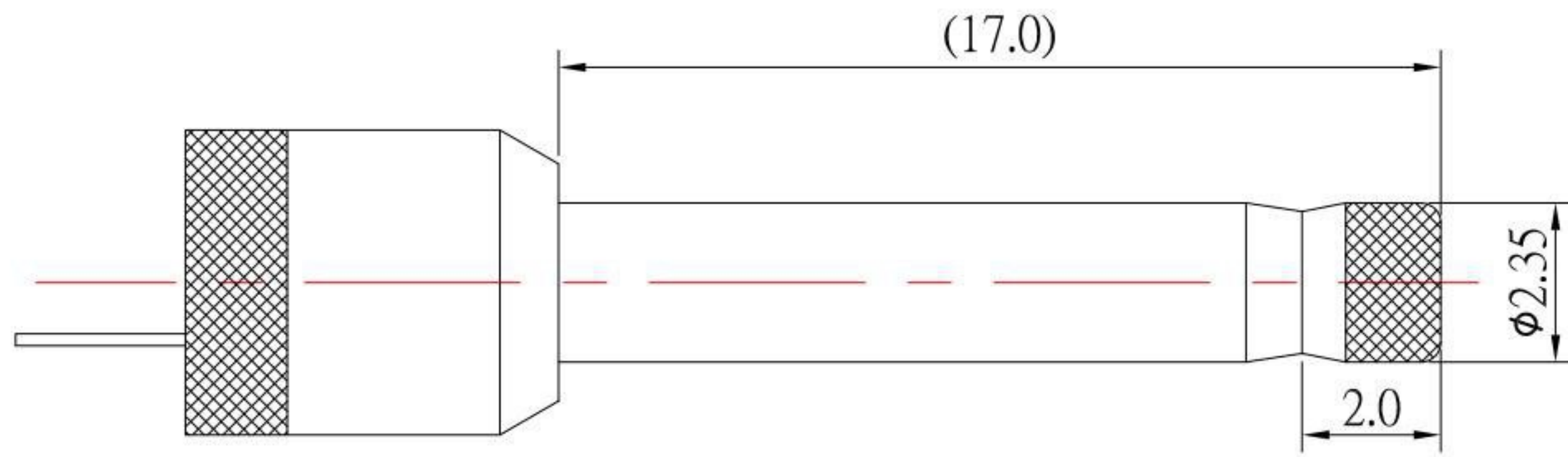
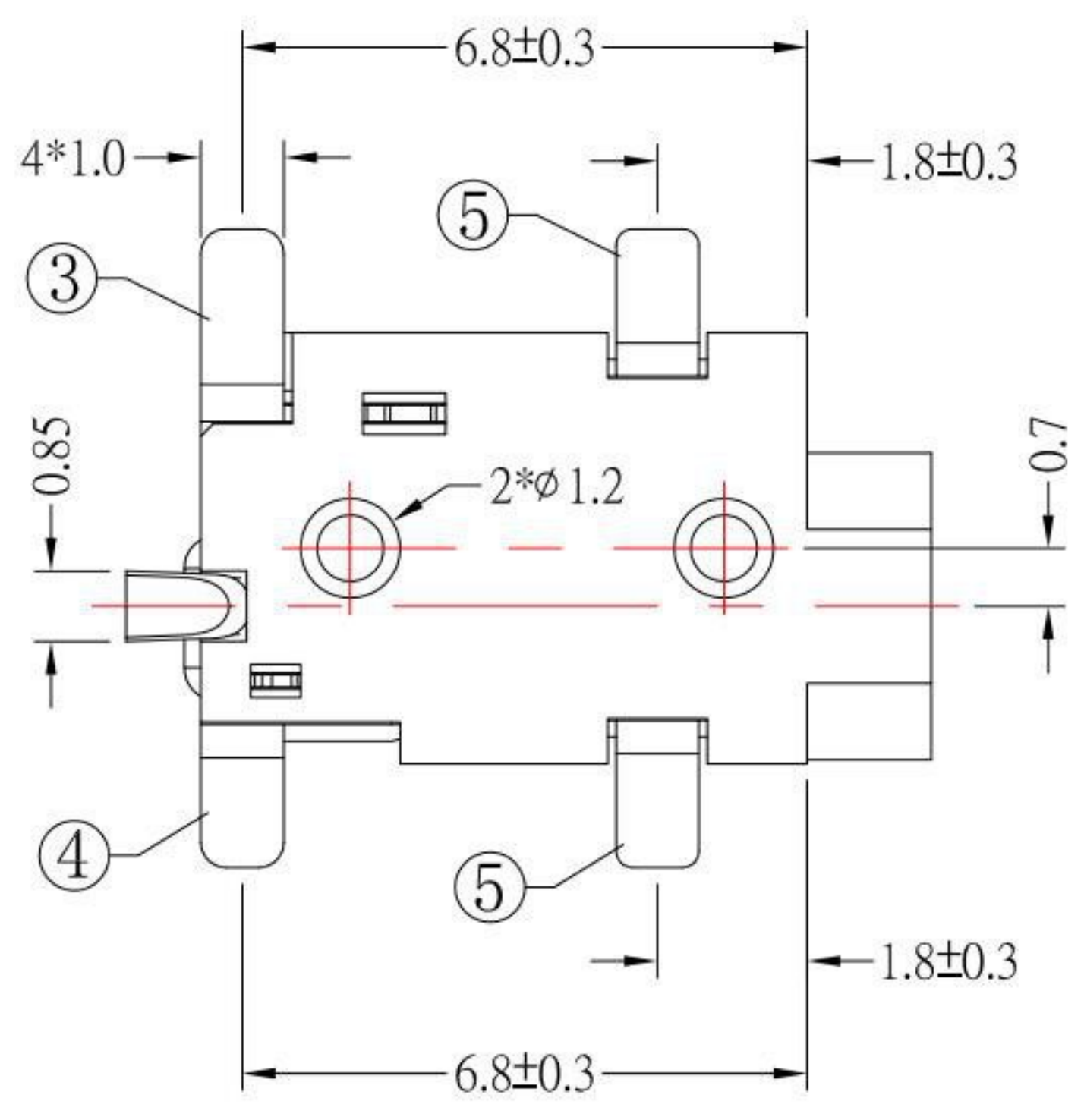

RECOMMENDED PLUG

SPECIFICATION

1. Rating : DC 16V , 1.0A
2. Contact resistance : ≤ 50mΩ
3. Insulation resistance : ≥ 100MΩ
4. Withstand voltage : 500VAC
5. Insertion and extraction force : 3-30N
6. life test : 5,000 cycles °

MODEL NO.	DC-065D-0.65
SCHMATIC	

NO.	DESCRIPTION	QTY	MATERIAL	PLATING
6	STOPPER	1	BRASS	Ag-Plating
5	SUPPORT	2	BRASS	Ag-Plating
4	CONTACT FOOT	1	BRASS	Ag-Plating
3	SPRING	1	PHOSPHOR BRONZE	Ag-Plating
2	PIN	1	BRASS	Ag-Plating
1	HOUSING	1	PA9T	

KSD 科斯达电子科技有限公司
 SWITCH CONNECTOR 全球 互联零组件制造企业
KSD ELECTRONIC TECHNOLOGY Co., LTD

TOLERANCE UNLESS OTHERWISE STATED :	Up to 5 ±0.2	3RD. ANGEL'S	UNITS	MM
	Above 5 ~ 15 ±0.3			
	Above 15 ~ 30 ±0.4			
	Above 30 ~ 50 ±0.5			
	Angle ±0.3			

DRAWN BY:	DATE	MAT'L	TITLE	JACK
Jack Lu	11/17/22		MODLE	DC JACK
CHECKED BY:	DATE	FINISH	DWG NO.	DC-065D-0.65-S124
Jacky Chen	11/17/22		PART NO.	DC-065D-0.65-S124
APPROVED BY:	DATE	SCALE	1:1	
Tony Kao	11/17/22	SHEET NO.	1 of 1	

ITEM NO.	DESCRIPTION	DRAWN	DATE
2	更新底部樣式	Jack	111722
1	更新料號	Jack	111622