

P.C.B LAYOUT
TOP VIEW

SPECIFICATION

1. Rating : DC 20V, 10.0A
2. Contact resistance : $\leq 30m\Omega$
3. Insulation resistance : $\geq 100M\Omega$
4. Withstand voltage : 500VAC
5. Insertion and extraction force : 3-30N
6. life test : 5,000 cycles

Model NO.	DC-081HS-2.0	DC-081HS-2.5
PIN(X)	$\phi 2.0$	$\phi 2.5$

MODEL NO.	DC-081HS-x
SCHEMATIC	2
	4
	3

NO.	DESCRIPTION	QTY	MATERIAL	PLATING
6	COVER	1	SUS	
5	SPACER	1	SUS	
4	BERRY PIN	1	COPPER ALLOY	Ni-Plating
3	CCAW	1	PHOSPHOR BRONZE	Tin Plated over Ni
2	FOOT COVERLET	1	SPCC	Ni-Plating
1	HOUSING	1	PA9T (BLACK)	

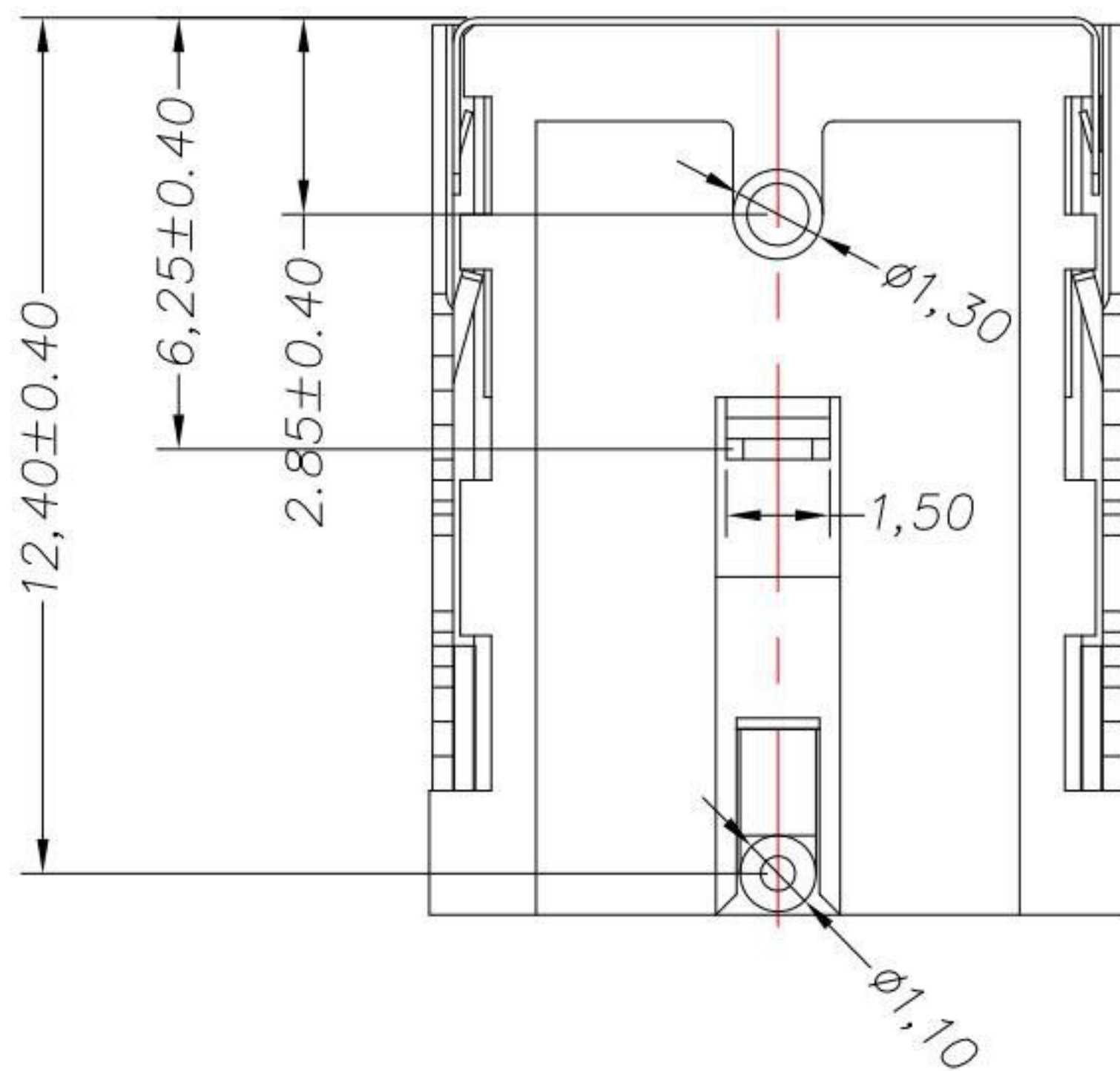

11	新增尺寸	Jack	063020	16	更新材質	Jack	082621
10	更新樣式	Jack	111819	15	更新尺寸公差	Jack	082521
9	更新尺寸及樣式	Lan	071619	14	更新鍍層	Jack	053121
8	更新圖面	Jack	052319	13	更新材質及鍍層	Jack	052821
7	更新圖面	Jack	052219	12	更新尺寸公差	Jack	082720

6	更新圖面	Jack	043018				
5	更新材質	Jack	010518				
4	更新圖面	Jack	122517				
3	更新材質	Jack	051117				
2	更新Rating	Jack	062016				
1	新增SPEC及PIN選項	Jack	121515				
ITEM NO.	DESCRIPTION	DRAWN	DATE				

KSD 科斯达电子科技有限公司
SWITCH CONNECTOR KSD ELECTRONIC TECHNOLOGY Co., LTD
全球 互聯零組件製造企業

TOLERANCE UNLESS OTHERWISE STATED: Up to 5 ± 0.2 , Above 5 ~ 15 ± 0.3 , Above 15 ~ 30 ± 0.4 , Above 30 ~ 50 ± 0.5 , Angle $\pm 0.3^\circ$

3RD. ANGEL'S UNITS MM

DRAWN BY:	DATE	MAT'L	TITLE	JACK
Jack Lu	08/26/21		MODLE	DC JACK
CHECKED BY:	DATE	FINISH	DWG NO.	DC-081HS-x-S214
Jacky Chen	08/26/21		PART NO.	DC-081HS-x-S214
APPROVED BY:	DATE	SCALE	SHEET NO.	1 of 1
Tony Kao	08/26/21	1:1		

SIZE	A4
VER	R16