

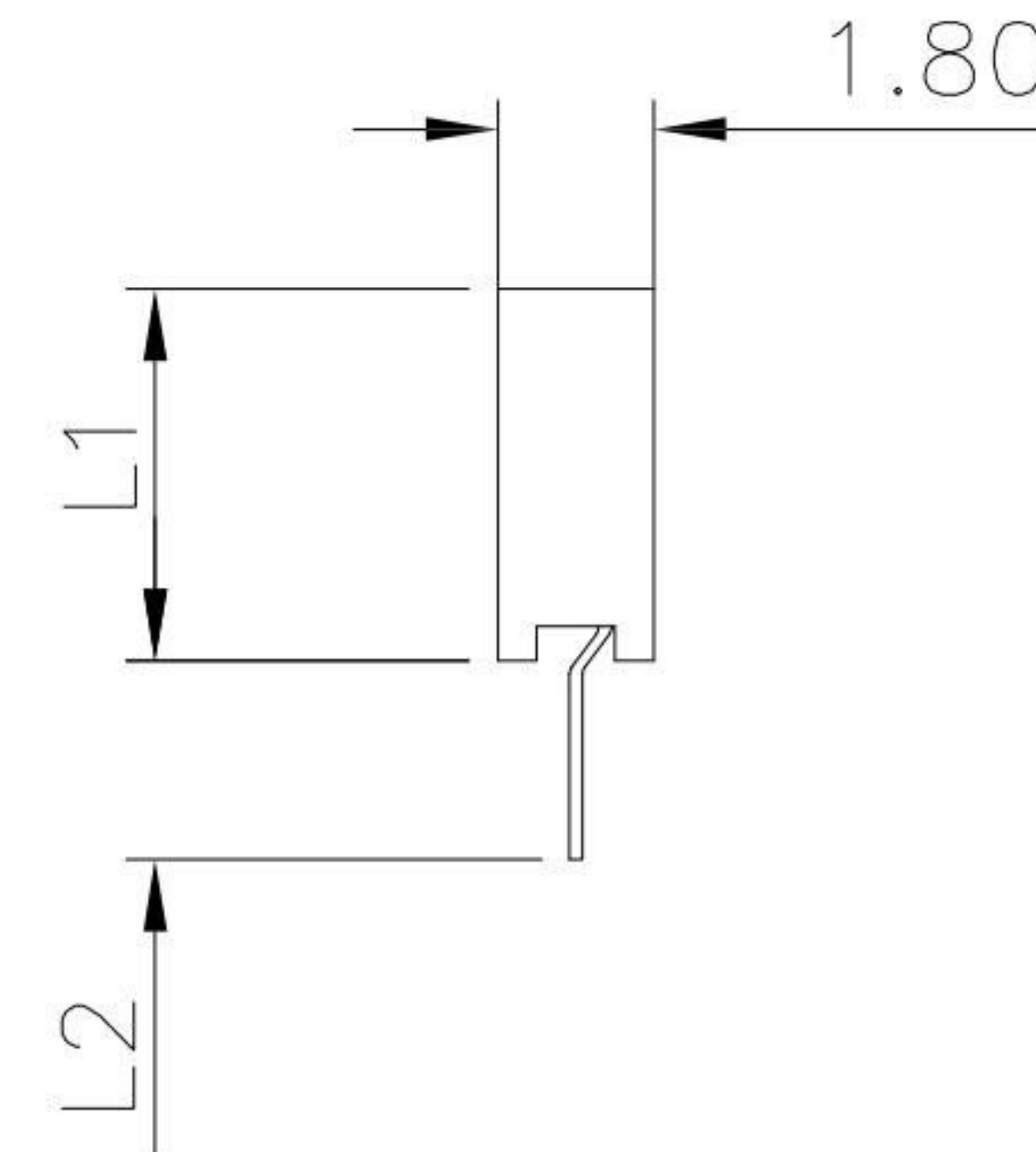

FH-C11-21xxx-S304

	L1	L2
A	3.40	2.40
B	4.30	2.40

PIN數



SPECIFICATIONS:

- 1.Current Rating : 1.0 A
- 2.Insulation Resistance : 1,000MΩ Min
- 3.Contact Resistance : 20mΩ Max
- 4.Operation Temperature : -40°C to +105°C

MATERIALS:

- 1.Insulator : LCP ,UL94V-0
- 2.Contact : Phosphor Bronze
- 3.Contact Plating : Gold over Nickel

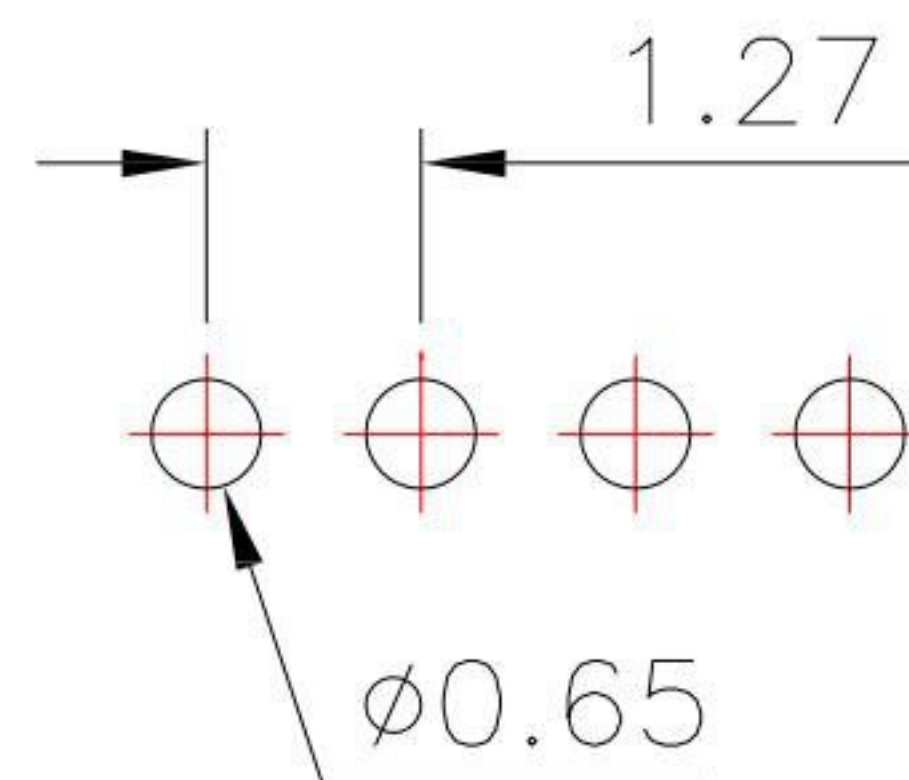
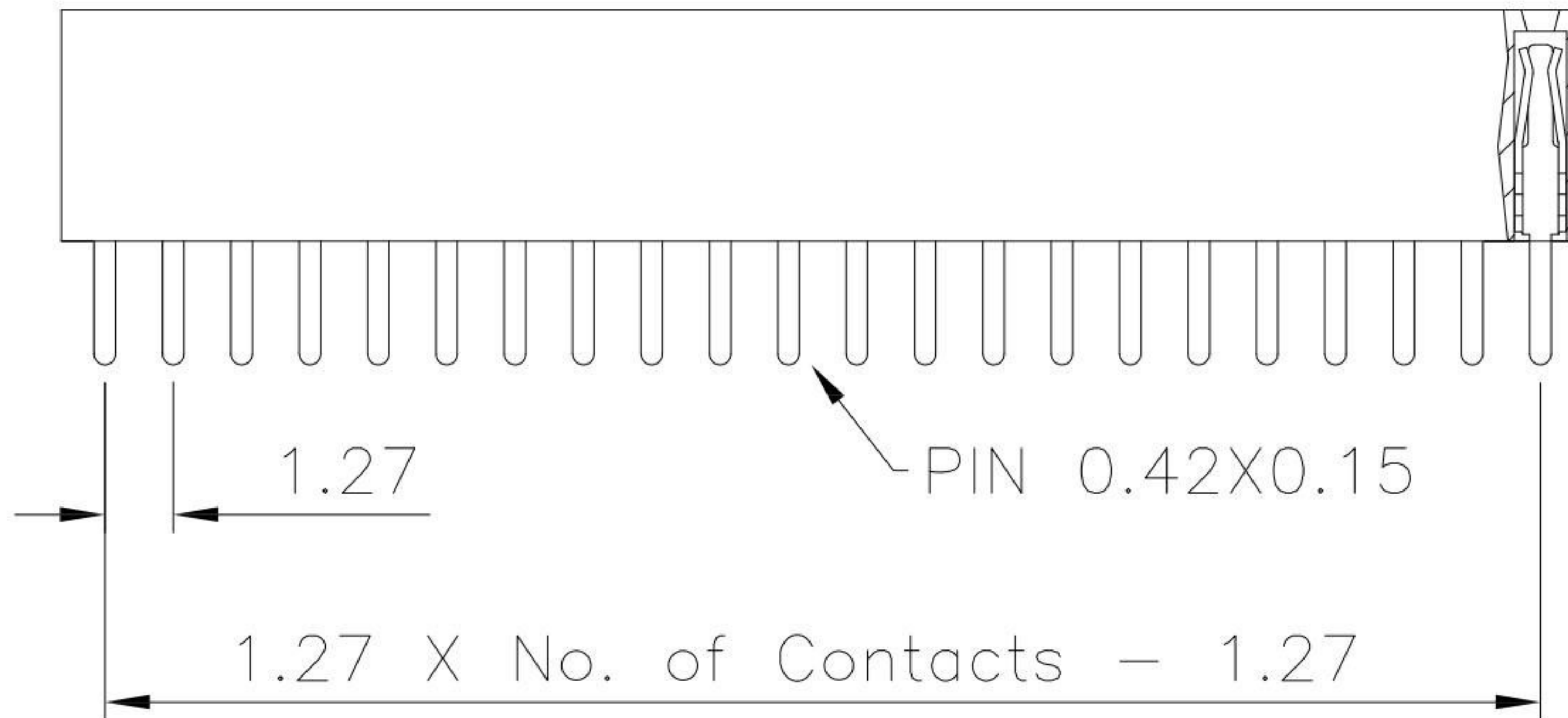
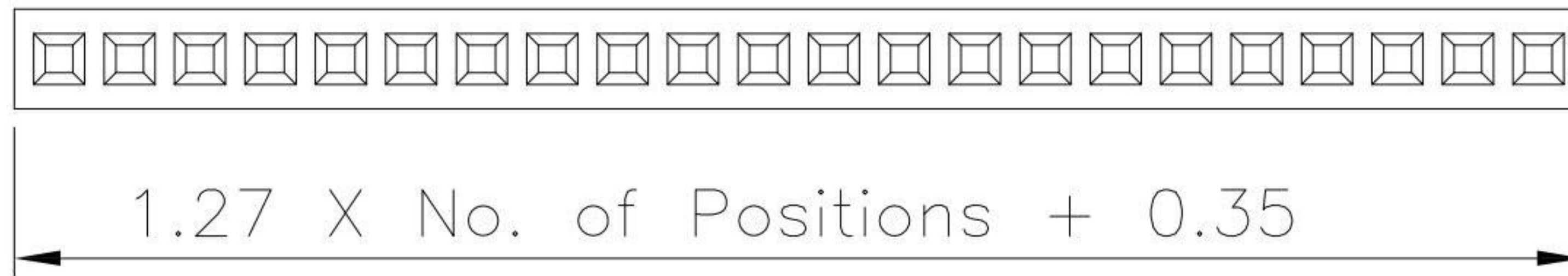

P. C. B. Layout

KSD 科斯达电子科技有限公司
 SWITCH CONNECTOR KSD ELECTRONIC TECHNOLOGY Co., LTD
 全球 互联零组件制造企业

TOLERANCE UNLESS OTHERWISE STATED:	Up to 5 ±0.2	3RD. ANGEL'S	UNITS	MM
	Above 5 ~ 15 ±0.3			
	Above 15 ~ 30 ±0.4			
	Above 30 ~ 50 ±0.5			

DRAWN BY:	DATE
Jack Lu	10/03/16
CHECKED BY:	DATE
Jacky Chen	10/03/16
APPROVED BY:	DATE
Tony Kao	10/03/16

MAT'L	TITLE	Female Header
FINISH	MODLE	1.27 Female Header DIP
SCALE	DWG NO.	FH-C11-21xxx-S304
SHEET NO.	PART NO.	FH-C11-21xxx-S304

SIZE	A4
VER	R

ITEM NO.	DESCRIPTION	DRAWN	DATE