

RECOMMENDED P.C.B. LAYOUT

NOTE:

- 1.MATERIAL:
 - 1.1 HOUSING: LCP , BLACK
 - 1.2 CONTACT: BRASS
 - 1.3 SHEEL: SPCC
- 2.PLATING :
 - 2.1 CONTACT: PLATED GOLD IN MATING AREA ;
TIN PLATED ON SOLDER BALLS ;
NICKEL UNDER PLATED OVERALL
 - 2.2 SHELL: GOLD UNDER PLATED SURFACE LAYER
- 3.SPECIFICATIONS :
 - 3.1 ELECTRICAL CHARACTERISTICS
 - 3-1 . CURRENT RATING: 0.5 A
 - 3-2 . VOLTAGE RATING: 40 V
 - 3-3 . CONTACT RESISTANCE: 30m Ω MAX
 - 3-4 . INSULATION RESISTANCE:100M Ω MIN
 - 3-5 . DIELECTRIC WITHSTANDING VOLTAGE: 500V AC FOR 1 MINUTE
 - 4.LIFE TEST: 10000 CYCLES
 - 5.OPERATING TEMPERATURE: -25°C TO +85°C

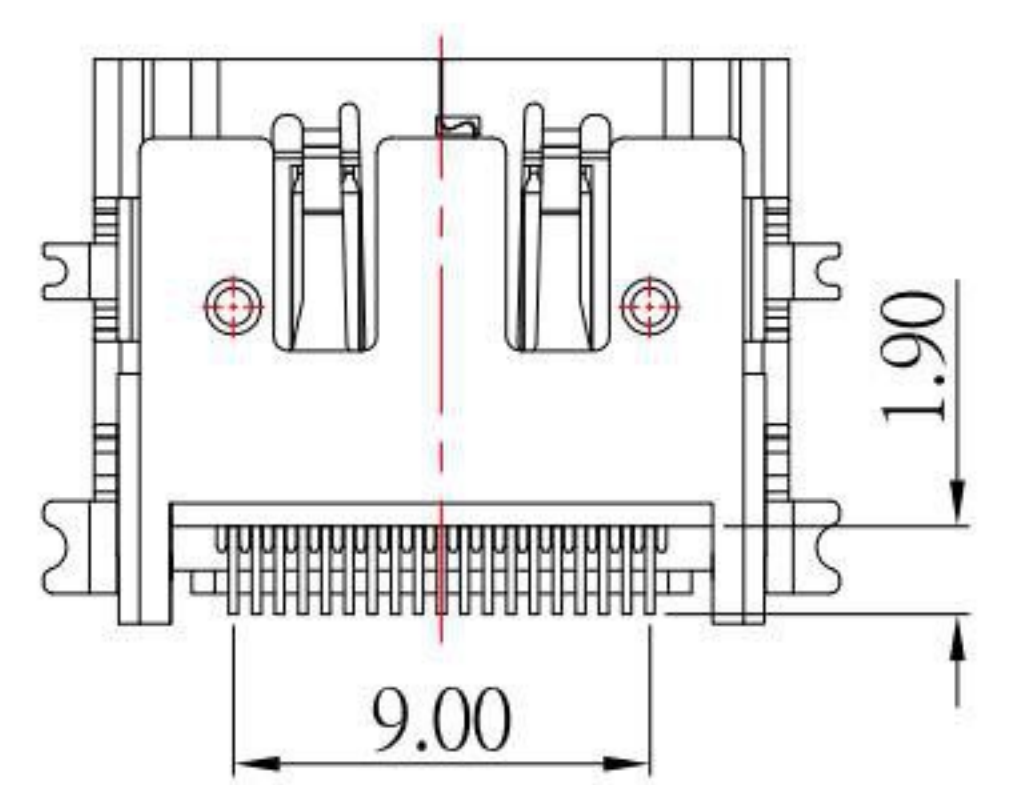
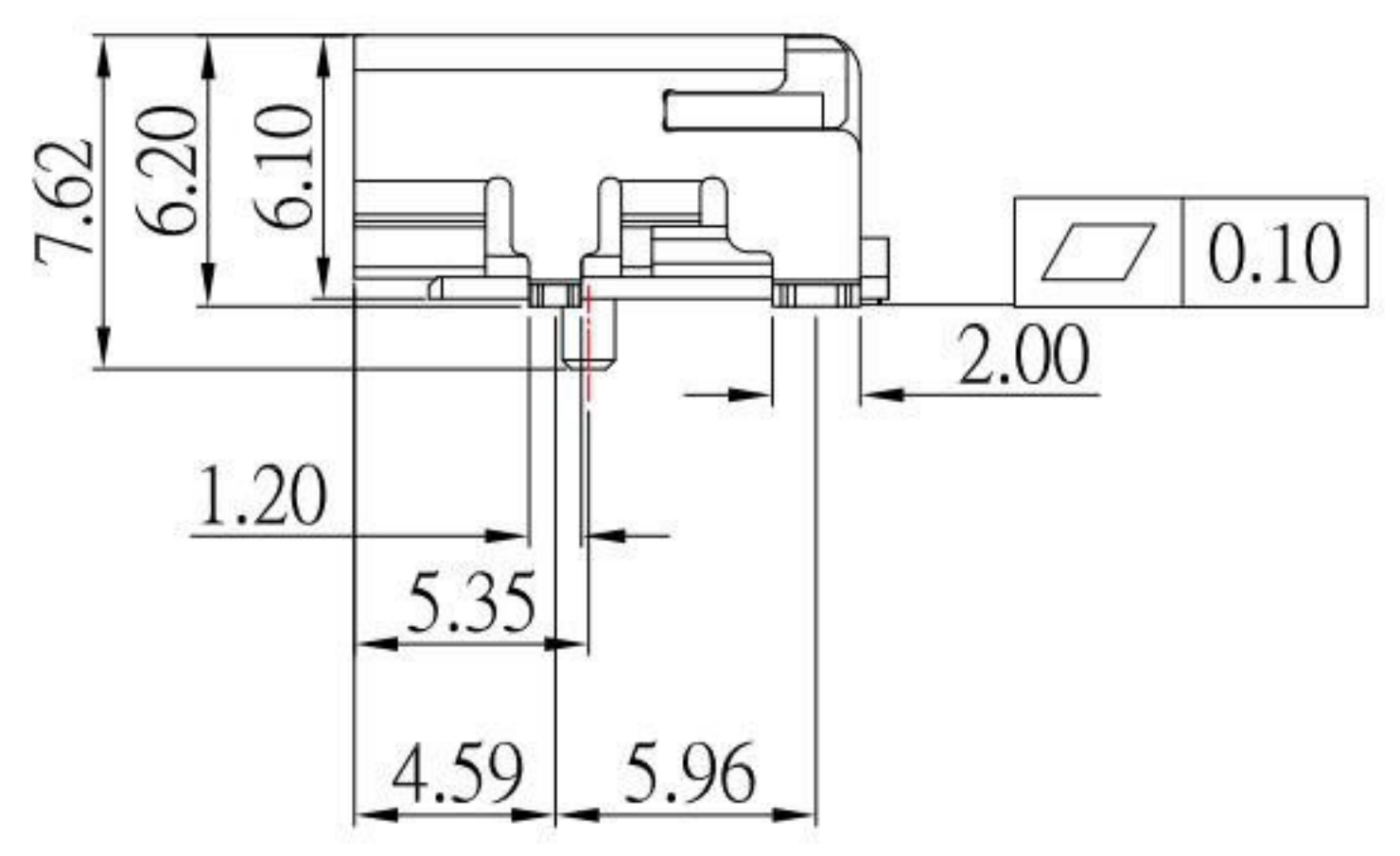
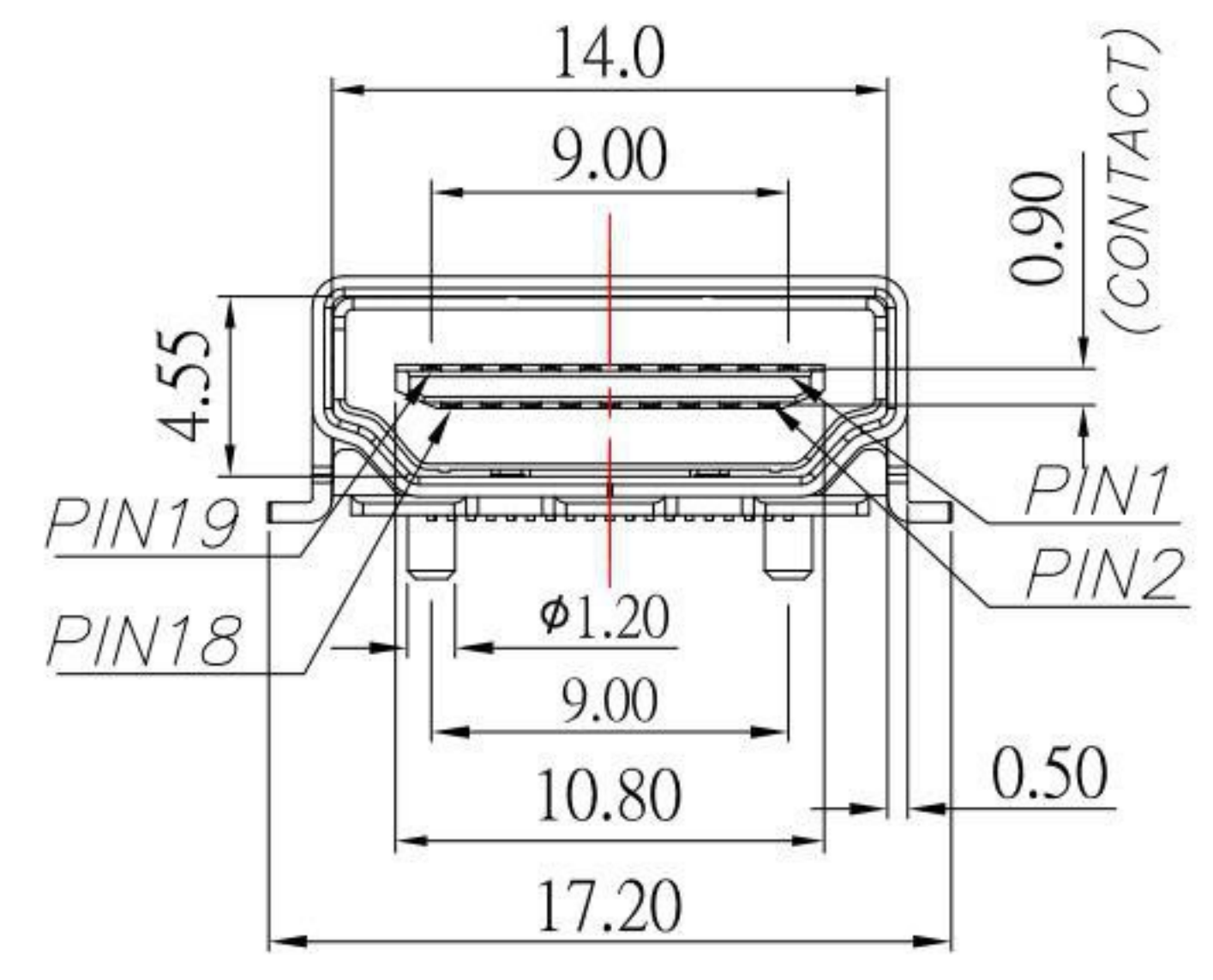

KSD 科斯达电子科技有限公司
 SWITCH CONNECTOR KSD ELECTRONIC TECHNOLOGY Co., LTD
 全球 互联零组件制造企业

TOLERANCE UNLESS OTHERWISE STATED :	Up to 5 ±0.2	3RD. ANGEL'S	UNITS	MM
	Above 5 ~ 15 ±0.3			
	Above 15 ~ 30 ±0.4			
	Above 30 ~ 50 ±0.5			
	Angle ±0.3°			

DRAWN BY:	DATE	MAT'L	TITLE	CONNECTOR
Jack Lu	08/02/22			
CHECKED BY:	DATE	FINISH	MODLE	HDMI AF 全贴有柱
Jacky Chen	08/02/22			
APPROVED BY:	DATE	SCALE	DWG NO.	HDMI-19P-SESI-S297
Tony Kao	08/02/22	1 : 1		
		SHEET NO.	PART NO.	HDMI-19P-SESI-S297
		1 of 1		
				SIZE A4
				VER R1

1	更新圖面	Jack	080222
ITEM NO.	DESCRIPTION	DRAWN	DATE