

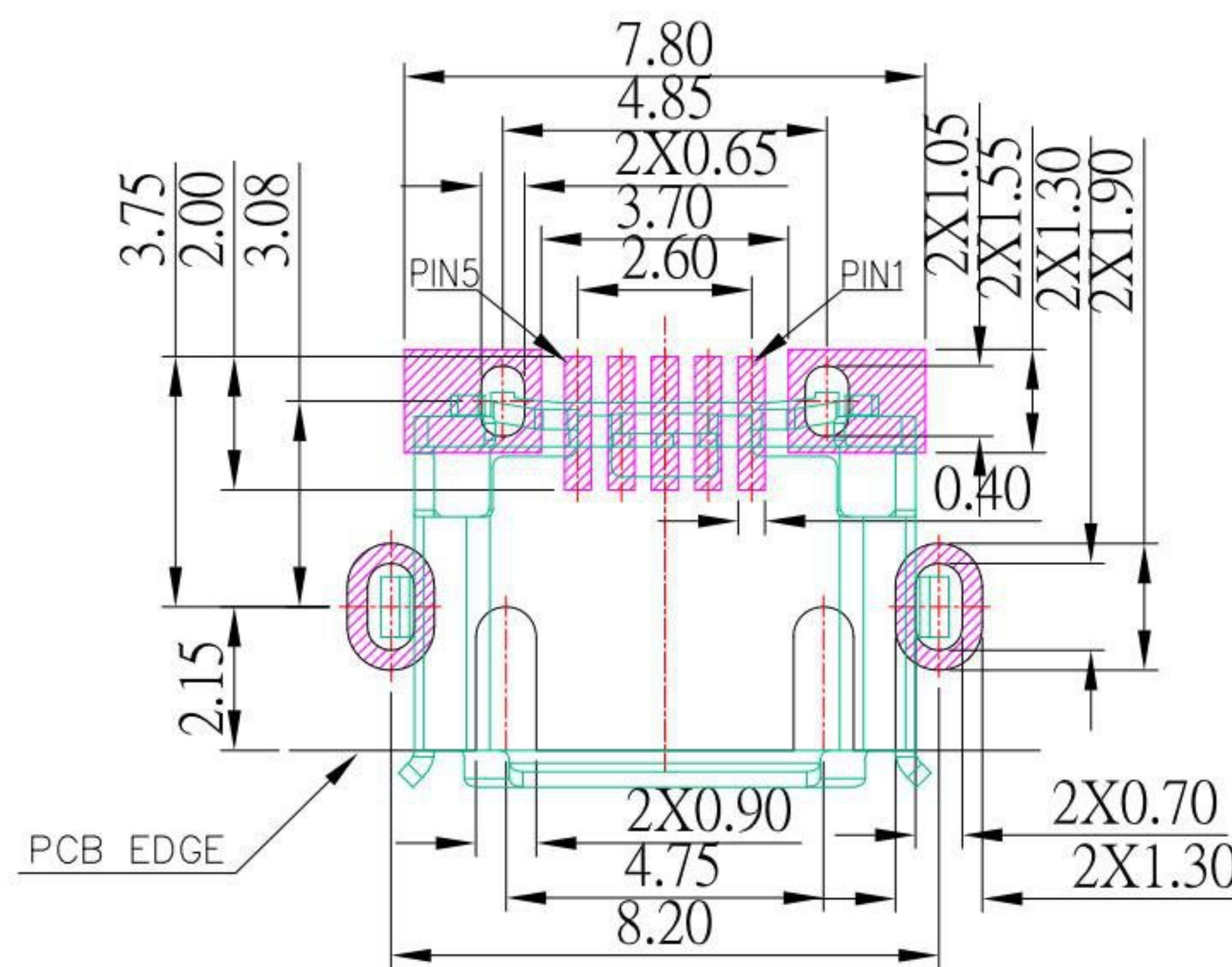

# MRUSB-5B-RV6x-S331

SHELL 鍍層:

TN
NI

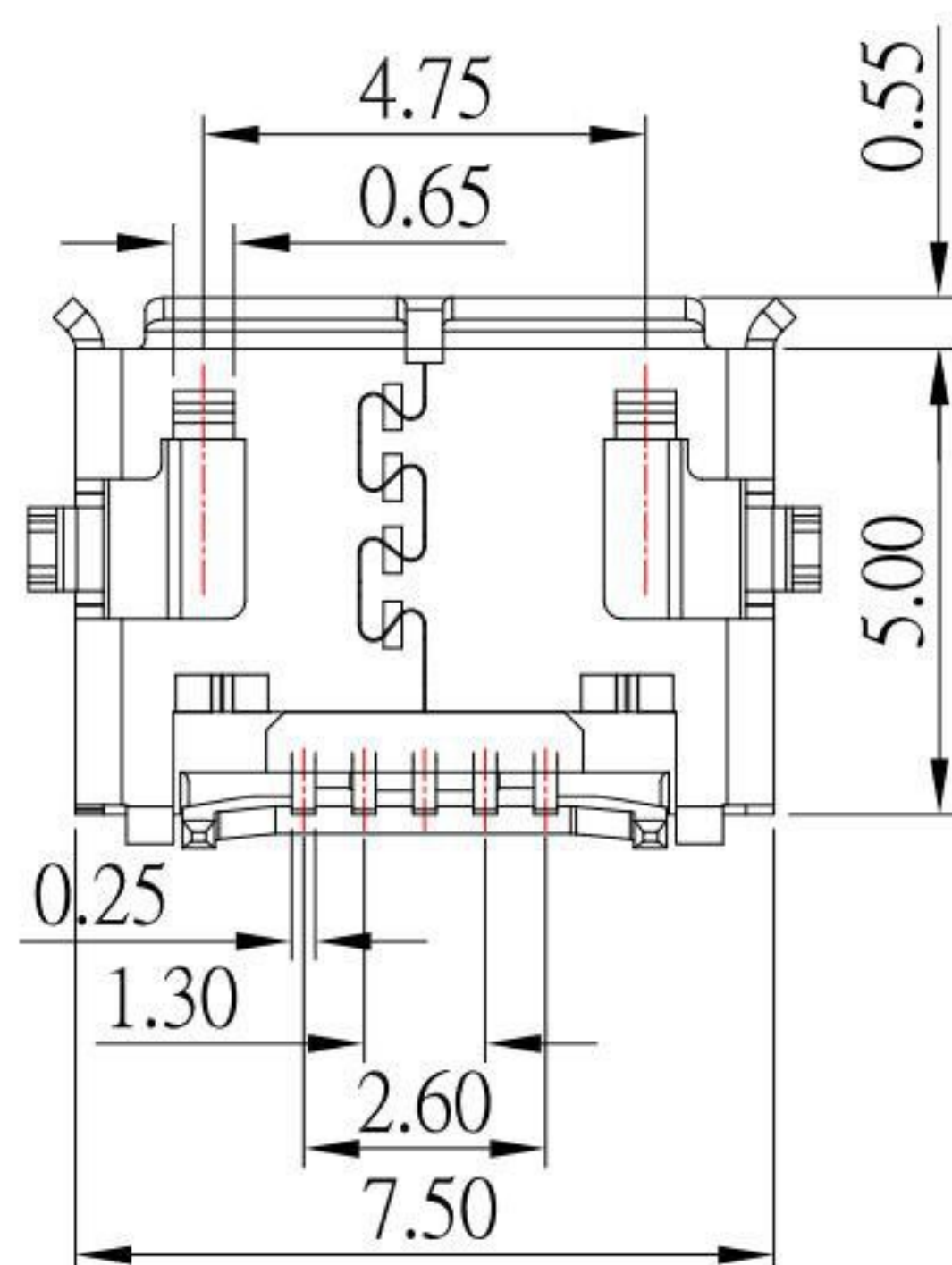
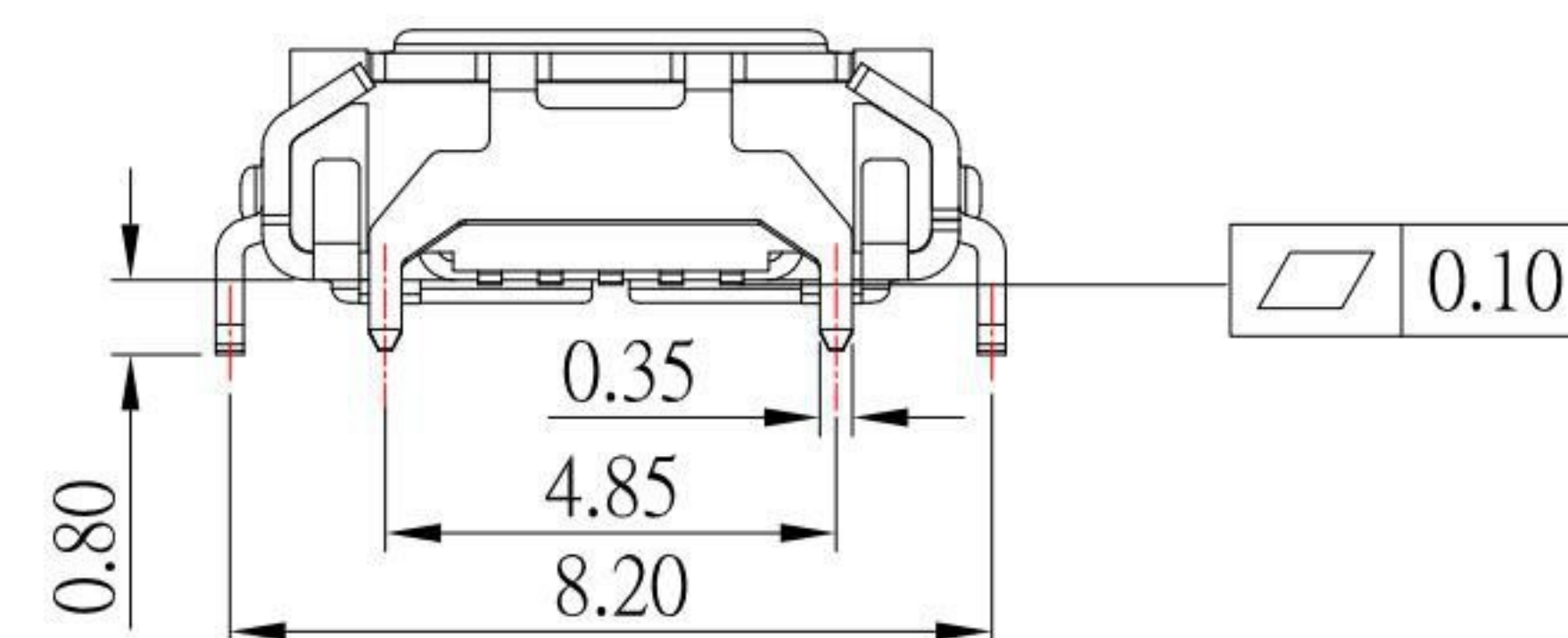
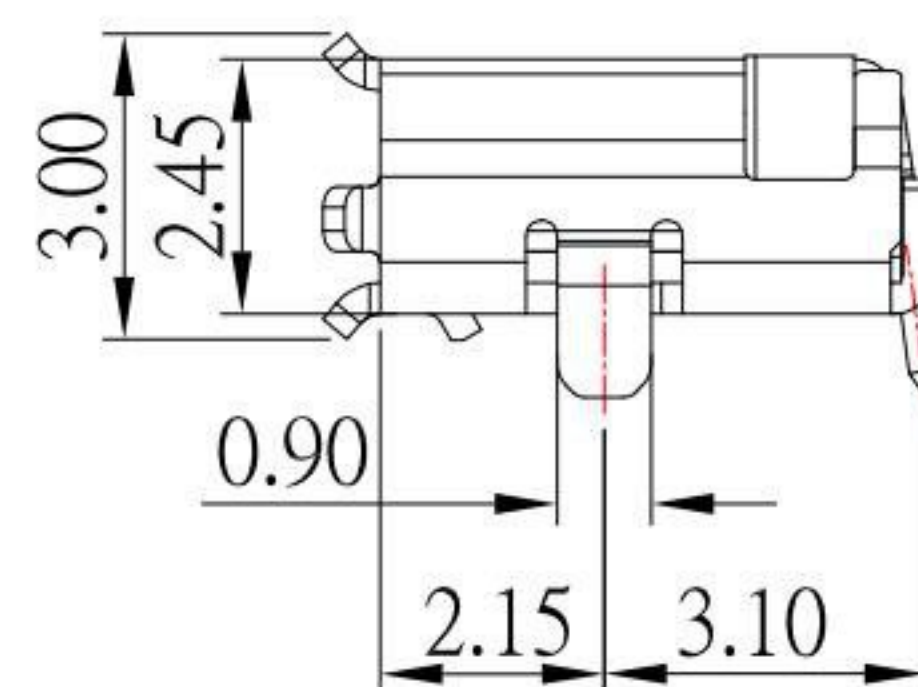
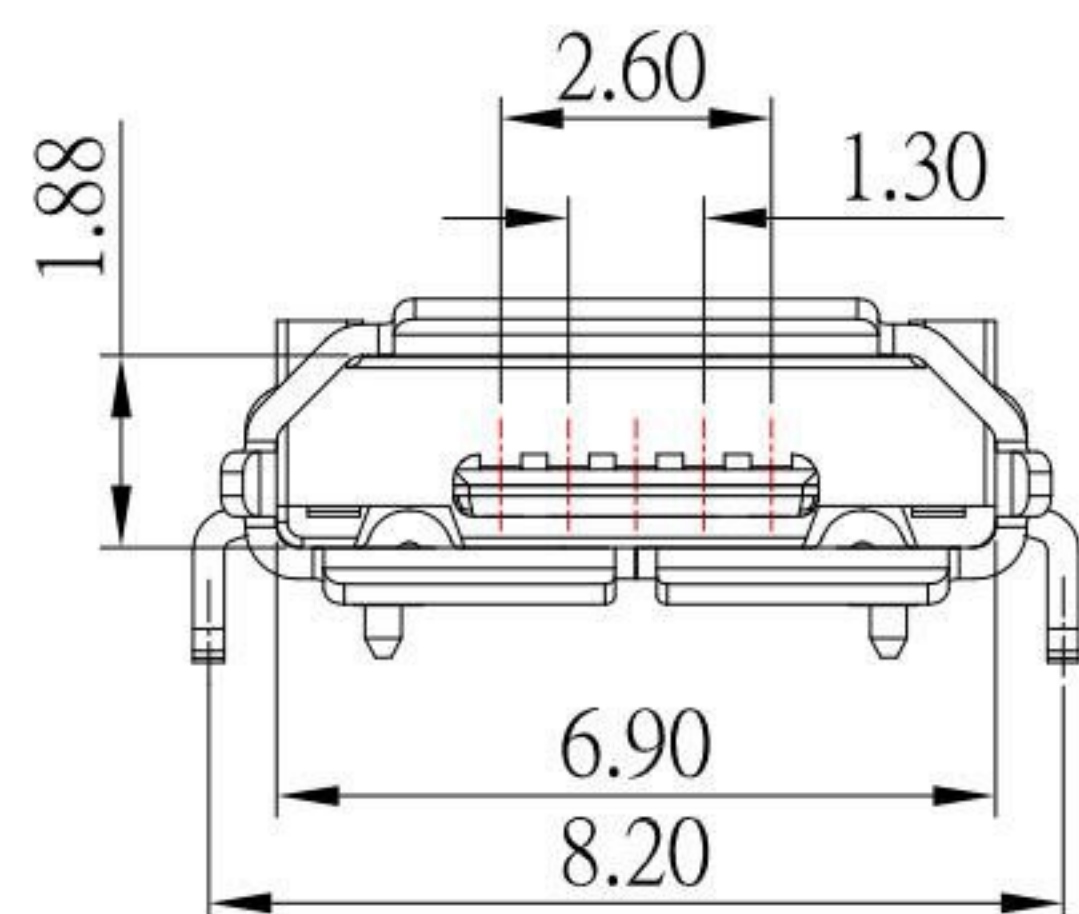
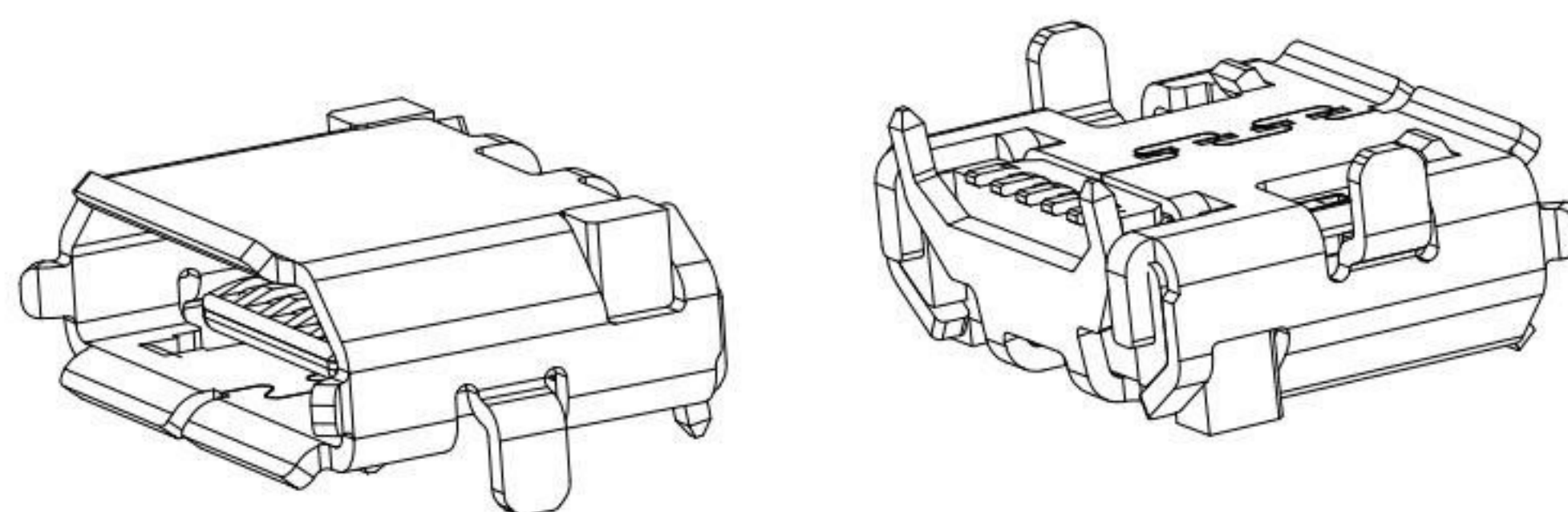
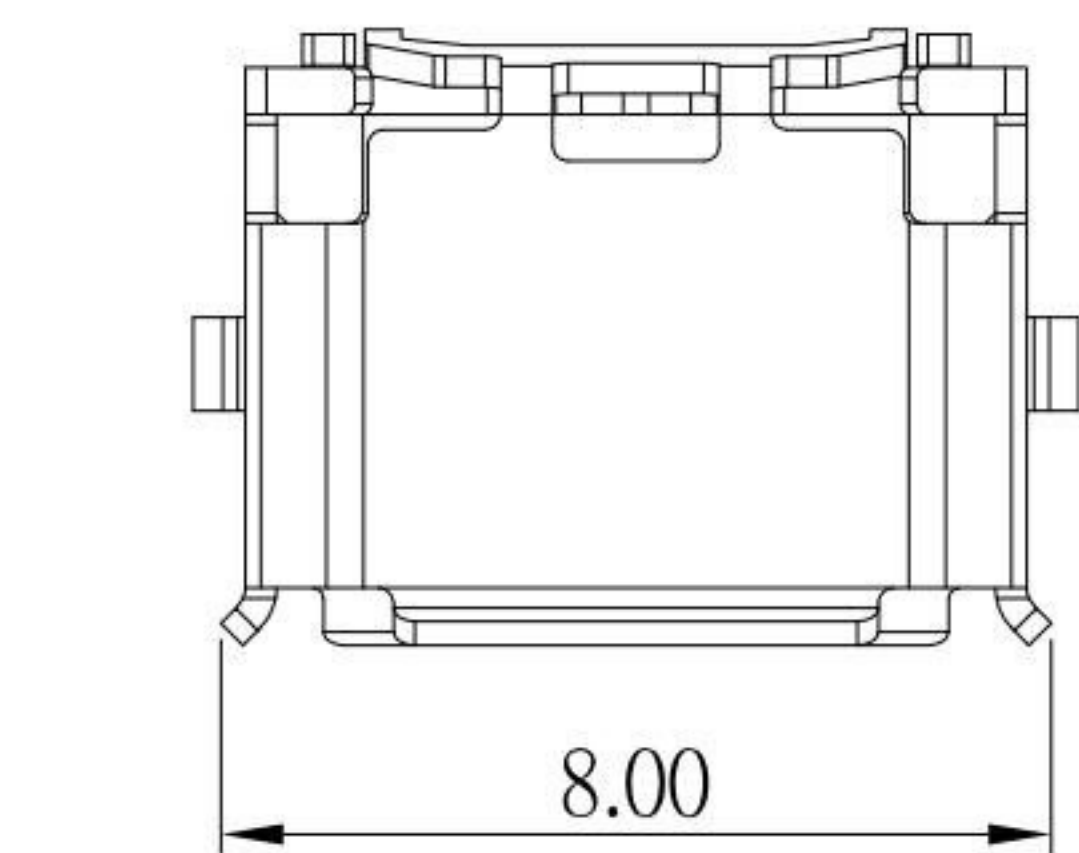

P.C.B LAYOUT MOUNTING PATTERN

**NOTES:**

**MATERIAL:**

- 1.1 HOUSING: LCP,Black
- 1.2 CONTACT: BRASS
- 1.3 SHELL: SUS

**Finish:**

- 2.1 Contact: Plated Gold in Mating Area ;  
Gold Plated on Solder Balls  
Nickel under plated overall
- 2.2 Shell: Tin under Plated surface layer

**3.SPECIFICATION:**

- 3.1 RATING: 30V AC , 0.5 A(2,3,4 pin) ; 1.8 A(1,5 pin)
- 3.2 DIELECTRIC WITHSSTANDING VOLTAGE: 250 VAC
- 3.3 CONTACT RESISTANCE: 30 mΩ MAX.
- 3.4 INSULATION RESISTANCE: 100 MΩ MIN.
- 3.5 TEMPERATURE RANGE: -30°C ~ +85°C

**KSD** 科斯达电子科技有限公司  
SWITCH CONNECTOR 全球 互联零组件制造企业  
KSD ELECTRONIC TECHNOLOGY Co., LTD

TOLERANCE UNLESS OTHERWISE STATED:	Up to 5 ±0.2	3RD. ANGEL'S	UNITS	MM
	Above 5 ~ 15 ±0.3			
	Above 15 ~ 30 ±0.4			
	Above 30 ~ 50 ±0.5			
	Angle ±0.3°			

DRAWN BY:	DATE
Jack Lu	02/25/19
CHECKED BY:	DATE
Jacky Chen	02/25/19
APPROVED BY:	DATE
Tony Kao	02/25/19

MAT'L	TITLE	CONNECTOR
FINISH	MODLE	MICRO USB 反向 外殼4 腳插板 (PH8.2-4.85mm)
SCALE	DWG NO.	MRUSB-5B-RV6x-S331
SHEET NO.	PART NO.	MRUSB-5B-RV6x-S331
	SIZE	A4
	VER	R

1	新增SHELL 鍍層選項及更新pcb layout	Jack	022519
ITEM NO.	DESCRIPTION	DRAWN	DATE