

### PCB LAYOUT

TF CARD PIN ASSIGNMENT

PIN NO.	PIN ASSIGNMENT
T1	DAT2
T2	CD/DAT3 <sup>2</sup>
T3	CMD
T4	VDD
T5	CLK
T6	VSS
T7	DAT0
T8	DAT1

SIM pin assignment	
	Name
C1	VCC
C2	RST
C3	CLK
C4	Reserved
C5	GND
C6	VPP
C7	I/O
C8	Reserved

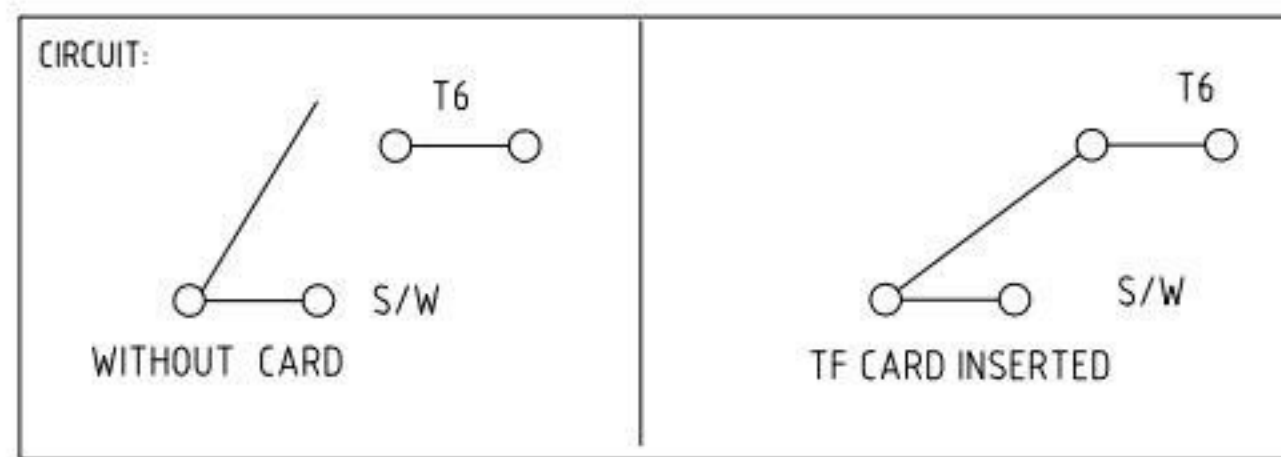
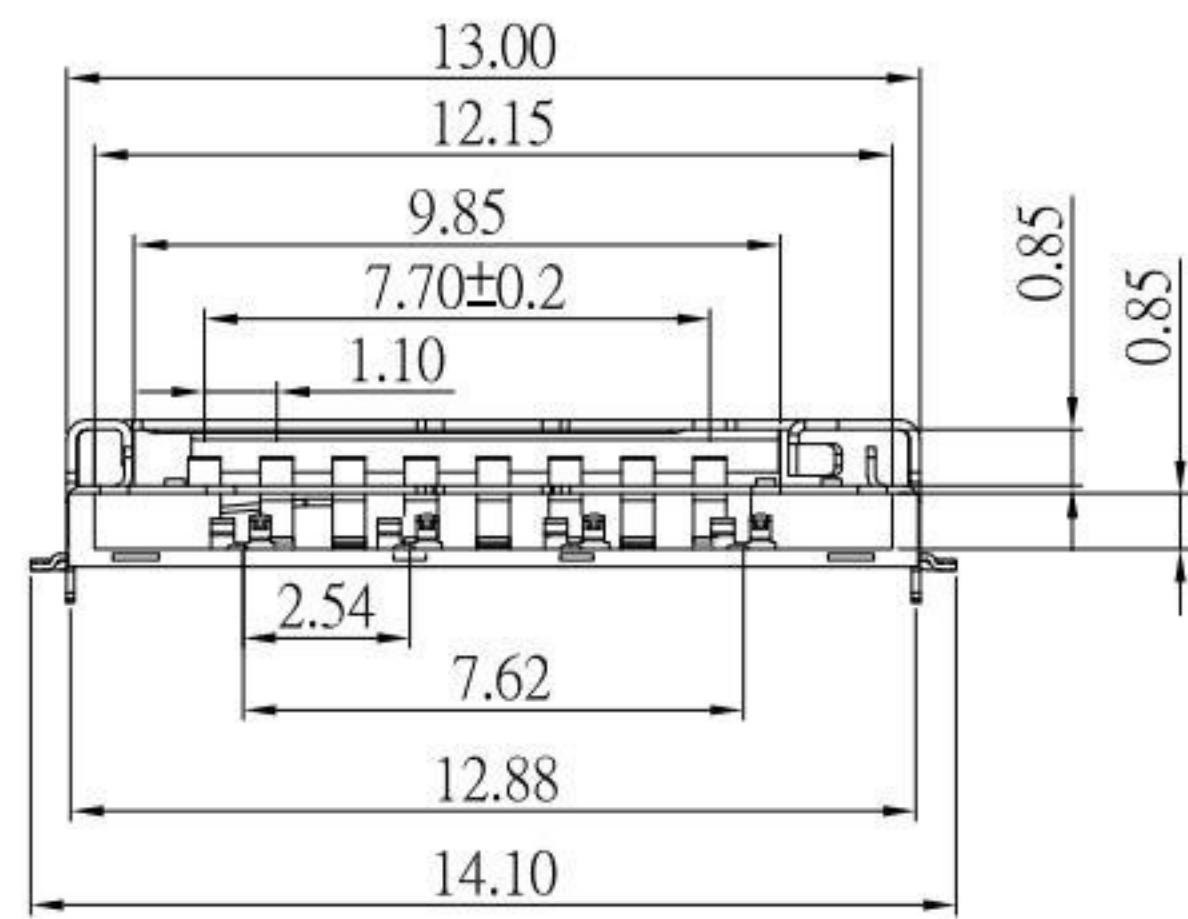

### SPECIFICATION

#### Electrical :

- 1.Current Rating: 0.5A , AC/DC
- 2.Contact Resistance: 100 mΩ Max.
- 3.Insulation Resistance: 500 MΩ Min.

#### Environmental:

- 1.Operating Temperature: -20°C ~ +85°C.

#### Material:

- 1.Housing: LCP
- 2.Contact: Copper Alloy
- 3.Shell: Stainless Steel

#### Finish:

- 1.Contact: Plated Gold in Mating Area ;  
Tin Plated on Solder Balls ;  
Nickel under plated overall
- 2.Shell: Nickel under Plated surface layer

**KSD** 科斯达电子科技有限公司  
 SWITCH CONNECTOR KSD ELECTRONIC TECHNOLOGY Co., LTD  
 全球 互联零组件制造企业

TOLERANCE UNLESS OTHERWISE STATED :  
 Up to 5 ±0.2  
 Above 5 ~ 15 ±0.3  
 Above 15 ~ 30 ±0.4  
 Above 30 ~ 50 ±0.5  
 Angle ±0.3

3RD. ANGEL'S

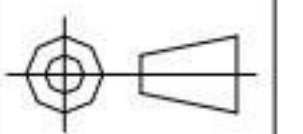

UNITS MM

DRAWN BY:	DATE
Jack Lu	04/24/20
CHECKED BY:	DATE
Jacky Chen	04/24/20
APPROVED BY:	DATE
Tony Kao	04/24/20

MAT'L	TITLE	CONNECTOR
FINISH	MODLE	MICRO SD + MICRO SIM 卡座二合一
SCALE 1 : 1	DWG NO.	MSISD-003-S267
SHEET NO. 1 of 1	PART NO.	MSISD-003-S267

ITEM NO.	DESCRIPTION	DRAWN	DATE
I	更新圖面	Jack	042420

SIZE	A4
VER	R1