

PCB LAYOYT

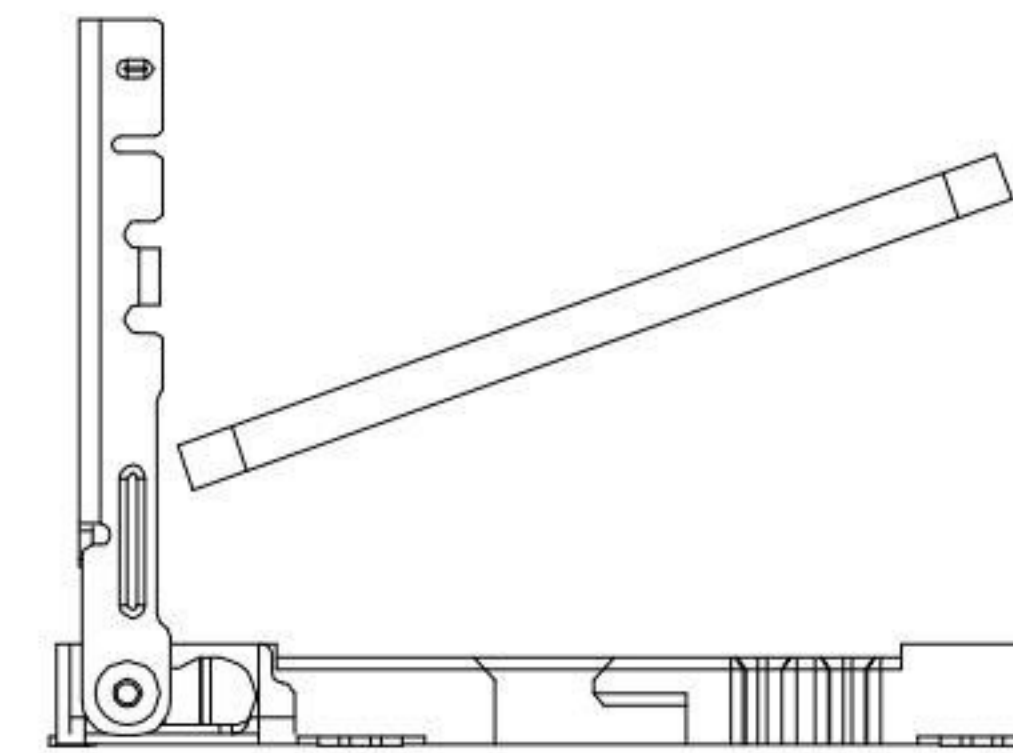

STEP 1 INSERT NANO SIM CARD

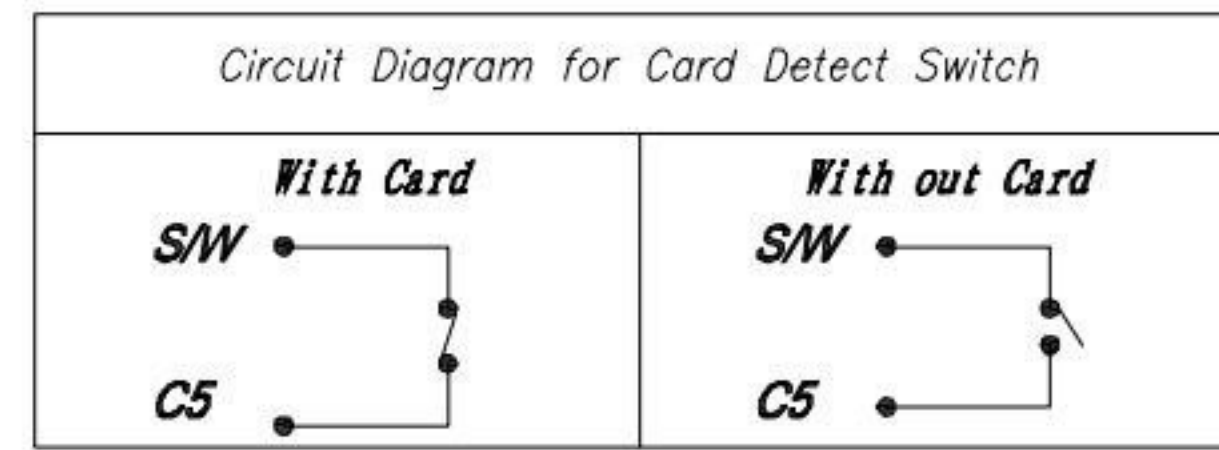
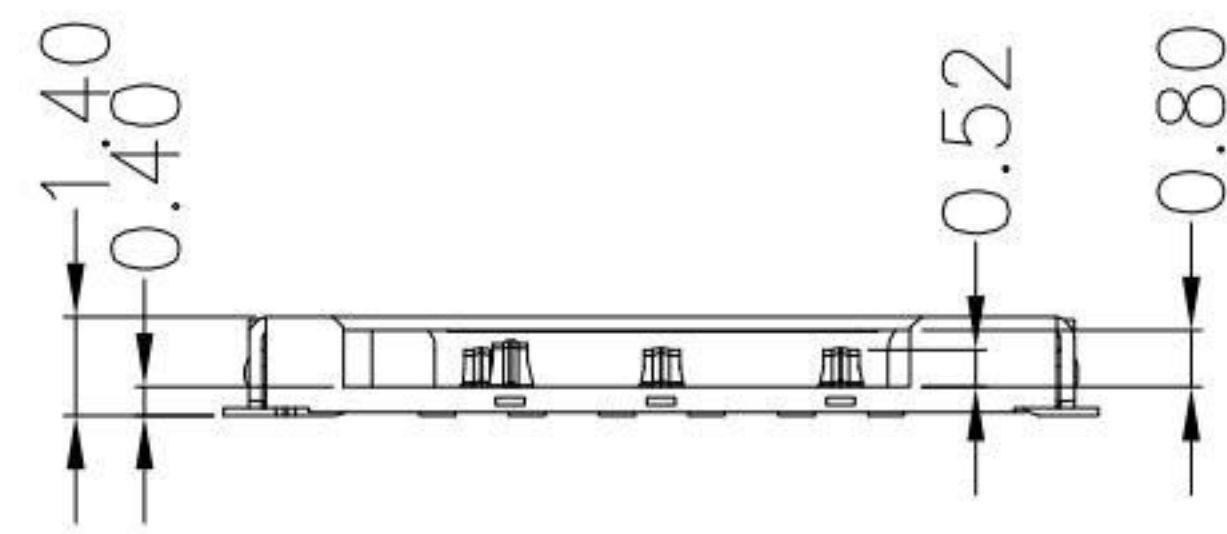
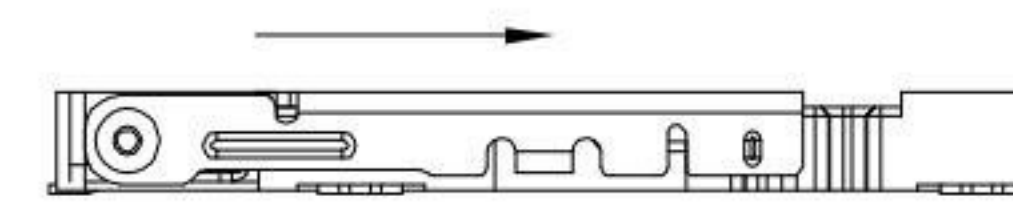

STEP 2 PUSH THE SHELL

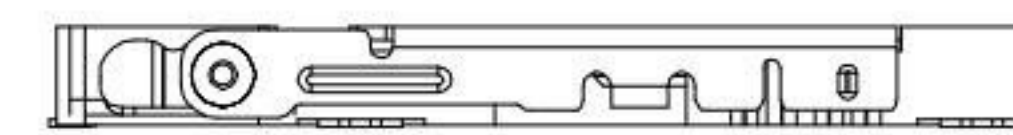

STEP 3 FINISH

SPECIFICATION

Electrical :

- 1.Current Rating: 1.0A AC / DC
- 2.Voltage Rating: 125V AC / DC
- 3.Contact Resistance: 80 mΩ Max.
- 4.Insulation Resistance: 100 MΩ Min.

Environmental:

- 1.Operating Temperature: -20°C ~ +60°C.

Material:

- 1.Housing: LCP
- 2.Contact: Copper Alloy
- 3.Shell: Stainless Steel

Finish:

- 1.Contact: Plated Gold in Mating Area ;
Tin Plated on Solder Balls ;
Nickel under plated overall
- 2.Shell: Nickel under Plated surface layer

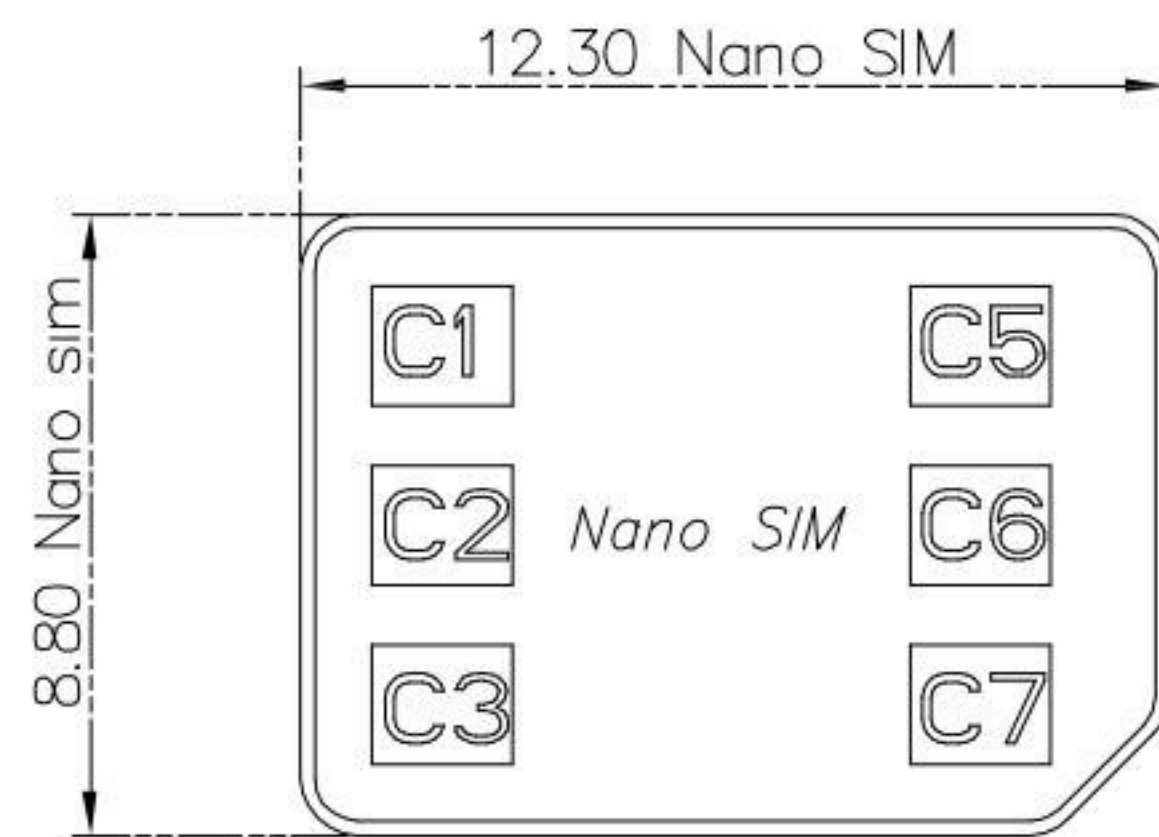

PIN NO.	PIN NAME
C1	VCC
C2	RST
C3	CLK
C5	GND
C6	VPP
C7	I/O
S/W	SWITSH PIN

KSD 科斯达电子科技有限公司
SWITCH CONNECTOR KSD ELECTRONIC TECHNOLOGY Co., LTD
全球 互 联 零 组 件 制 造 企 业

TOLERANCE UNLESS OTHERWISE STATED :
Up to 5 ±0.2
Above 5 ~ 15 ±0.3
Above 15 ~ 30 ±0.4
Above 30 ~ 50 ±0.5
Angle ±0.3

3RD. ANGEL'S

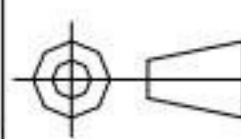

UNITS MM

DRAWN BY: Jack Lu
DATE: 04/14/21
CHECKED BY: Jacky Chen
DATE: 04/14/21
APPROVED BY: Tony Kao
DATE: 04/14/21

MAT'L
FINISH
SCALE 1 : 1
SHEET NO. 1 of 1

TITLE CONNECTOR
MODLE NANO SIM CARD CONNECTOR LIFTED COVER H:1.40 7P
DWG NO. NSIM-SFB007R-S304
PART NO. NSIM-SFB007R-S304

SIZE A4
VER R2

ITEM NO.	DESCRIPTION	DRAWN	DATE
2	更新Current Rating	Jack	041421
1	新增PCB LAYOUT中的標示	Jack	052920