

P. C. B LAYOUT

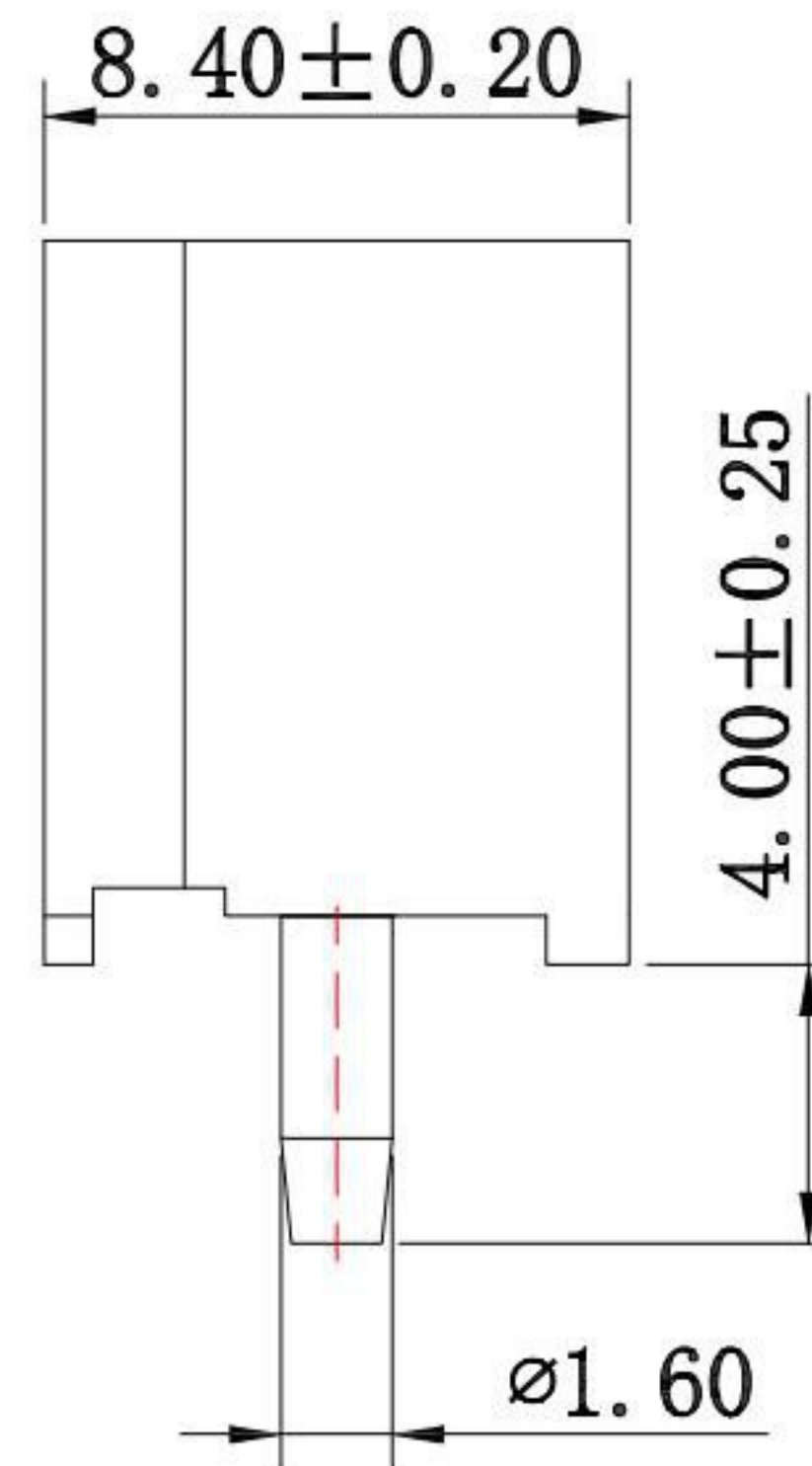
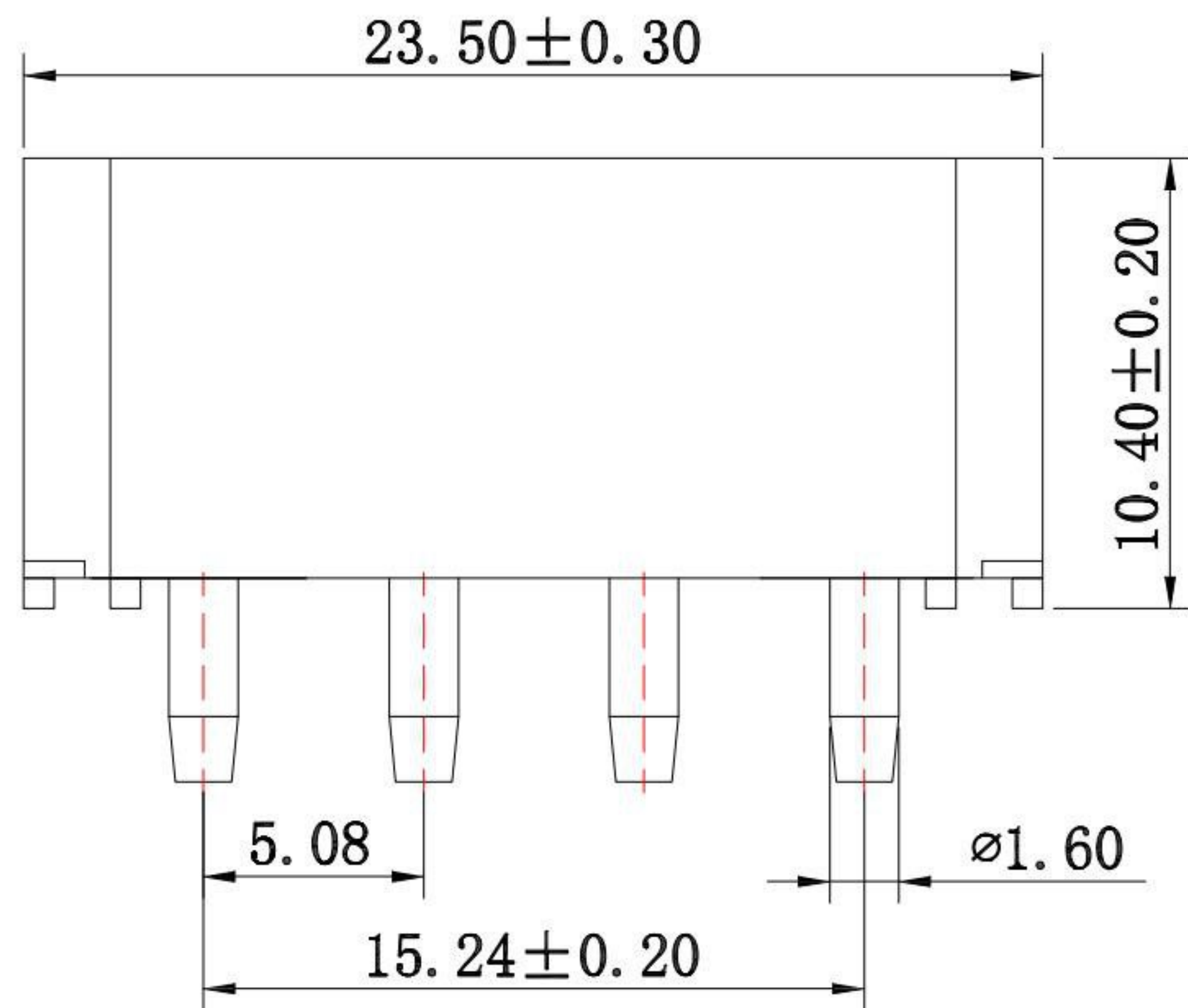

**SPECIFICATIONS**

Current rating : 5.0A AC , DC  
 Voltage rating : 250V AC , DC  
 Temperature rating :  $-25^{\circ}\text{C} \sim +85^{\circ}\text{C}$   
 Insulation resistance : 1,000 M $\Omega$  min.  
 Withstand voltage : 1,500V AC/minute  
 Contact resistance : 20 m $\Omega$ /Max  
 Material:  
 Base : Nylon66  
 Pin : Brass / Tin-plated

**KSD** 科斯达电子科技有限公司  
 SWITCH CONNECTOR KSD ELECTRONIC TECHNOLOGY Co., LTD  
 全球 互联零组件制造企业

TOLERANCE UNLESS OTHERWISE STATED :  
 Up to 5  $\pm 0.2$   
 Above 5 ~ 15  $\pm 0.3$   
 Above 15 ~ 30  $\pm 0.4$   
 Above 30 ~ 50  $\pm 0.5$   
 Angle  $\pm 0.3$

3RD. ANGEL'S

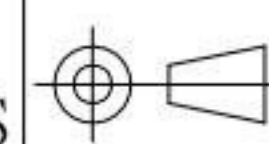

UNITS MM

DRAWN BY:	DATE	MAT'L	TITLE	CONNECTOR
Jack Lu	11/17/17			
CHECKED BY:	DATE	FINISH	MODLE	WAFER 5.08 DIP 大四P 180度
Jacky Chen	11/17/17			
APPROVED BY:	DATE	SCALE	DWG NO.	WF-5080VD04-S304
Tony Kao	11/17/17	1 : 1	PART NO.	WF-5080VD04-S304
SHEET NO.	1 of 1			

ITEM NO.	DESCRIPTION	DRAWN	DATE